

Description

Measure safety of the ground due to change of pore pressure by excavation.

Feature

- Waterproof and dustproof
- High precision and stability by Electric resistance type
- Long measurement by strong durability and safety
- Easy installation by small size and light weight
- Easy connection with automatic measuring equipment



Specification

Type	SPP - □ □
Capacity	2 ~ 20 kgf/cm ²
Rated Output	Approx. 0.6~1mV/V
Non-linearity	1% RO
Hysteresis	1% RO
Temperature Range	0 ~ 60°C
Over Load	1.5
Resistance	350Ω or 700 Ω
Allowable Exc. Voltage	10V
Electrical Connection	4Core Shield

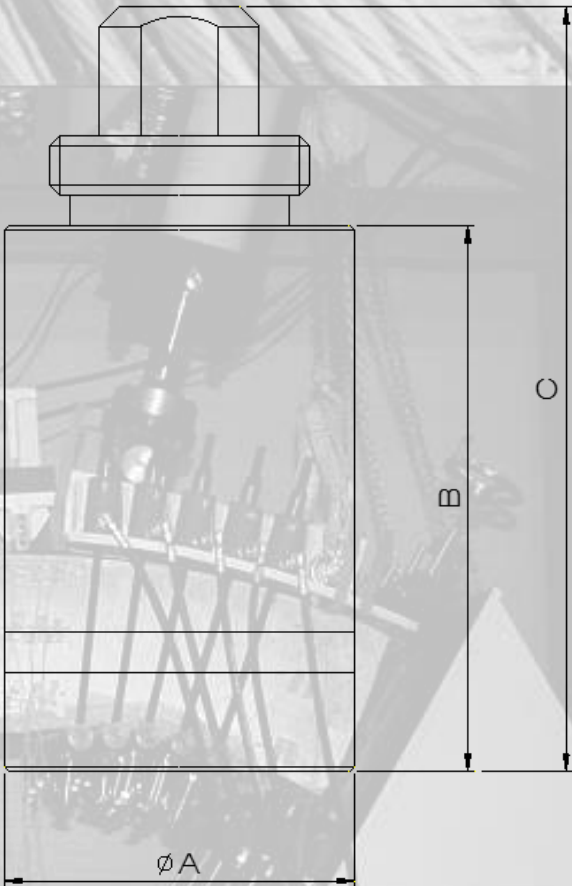

Dimension

Type	ØA	B	C
SPP-2	35	55	77
SPP-5	35	55	77
SPP-10	35	55	77
SPP-20	35	55	77